

CrewGo Mobile Office

USER GUIDE



Ergonomic Solutions
WHERE THE OFFICE MEETS THE ROAD

800.755.4950 • GOERGO.COM

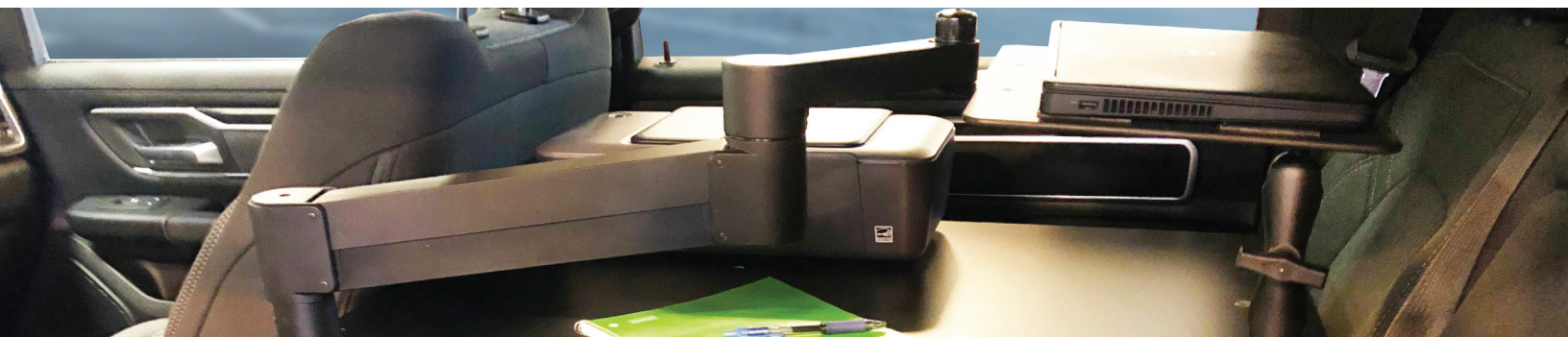

IMPORTANT INFORMATION

The CrewGo Desk transforms the rear seat of a Crew Cab pickup truck into a comfortable working environment. The desk is designed to safely accommodate a laptop and printer while providing enough space for storage and paperwork.

FOR YOUR SAFETY:

THE CREWGO DESK IS DESIGNED TO BE USED IN THE REAR SEAT OF A VEHICLE. DO NOT USE THE DESK WHILE THE VEHICLE IS IN MOTION. MAKE SURE THAT YOUR VEHICLE IS PARKED SAFELY AND THE TRANSMISSION IS NOT IN GEAR BEFORE USING THE DESK.

Contact Ergonomic Solutions at
800.755.4950 OR SUPPORT@GOERGO.COM
for questions or assistance with your CrewGo Mobile Office.



Note: Your desk and components may vary slightly from the pictures in the User Guide.

Mobile Office Features

Laptop Arm Counterbalance

The CrewGo Desk's articulating arm extends to place your laptop in an ideal ergonomic position. Working while sitting completely forward-facing reduces the risk of musculoskeletal disorders over time.

The Laptop Arm is counterbalanced to make it easy to maneuver. It may need to be adjusted to operate smoothly with your laptop. When the laptop arm is properly adjusted it will not rise or drop when in use.



Step #1

Place your laptop on the tray and then position the arm at the desired typing height.

If the arm drifts upward when you release it, use the Allen wrench provided to turn the adjustment screw clockwise.

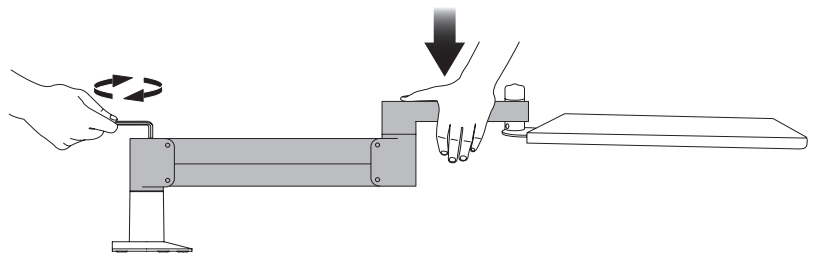

If the arm drifts downward when you release it, use the Allen wrench provided to turn the adjustment screw counter-clockwise.

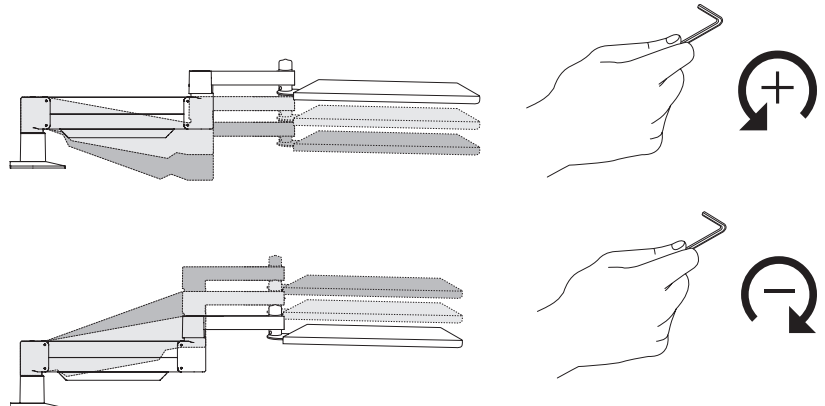

Depending on the weight of your laptop, you may have to turn the screw as many as 15-20 times.

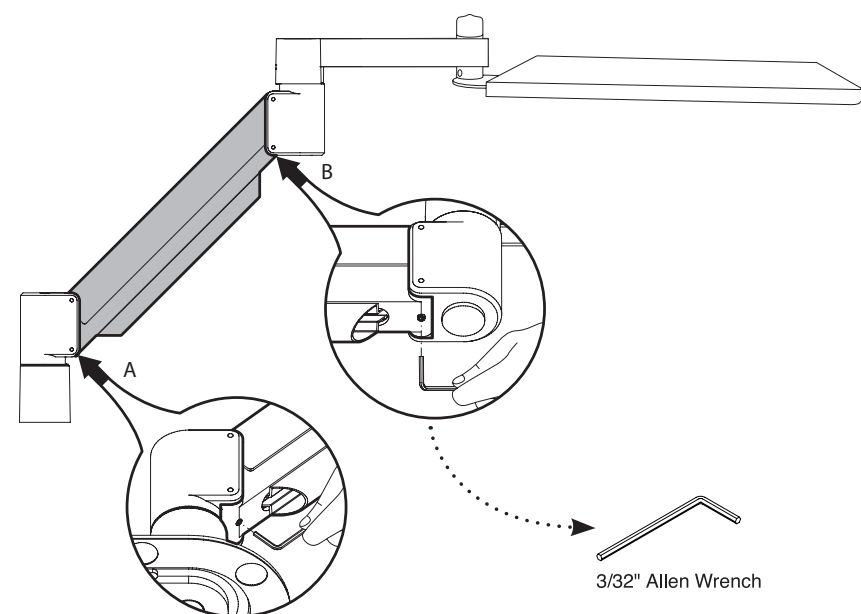

Step #2

In some instances, further counter-balance adjustments are needed to allow the arm's instant height adjustment function to work properly.

If your arm is not staying in position after performing step 1, follow these steps:

With the arm in the raised position, tighten set screw (A).

With the arm in the horizontal position, tighten set screw (B).

Do not over tighten screws.

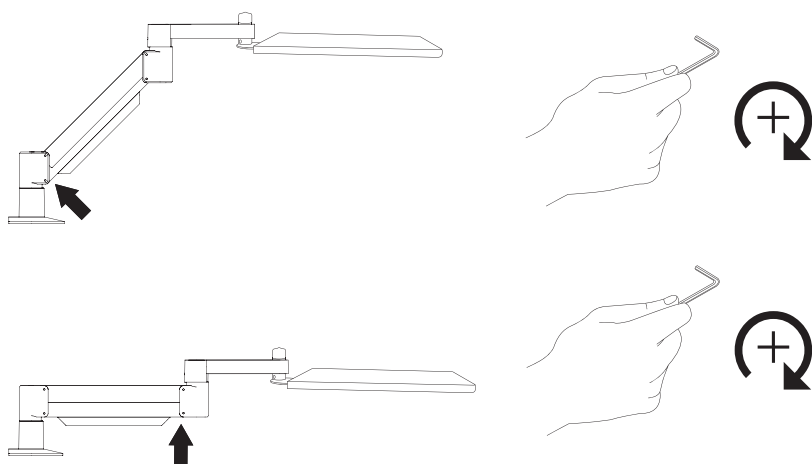

Laptop Arm Double Socket Ball Mount

The Laptop Arm Ball Mount is used to prevent the laptop arm and tray from moving while the vehicle is in motion. It should be used to secure the arm whenever the vehicle is being driven. The double socket arm should stay attached to the desktop ball, with the spring loaded end up, while the laptop arm is in use.

Note: Failure to use the mount could result in injury to you or damage to your vehicle.

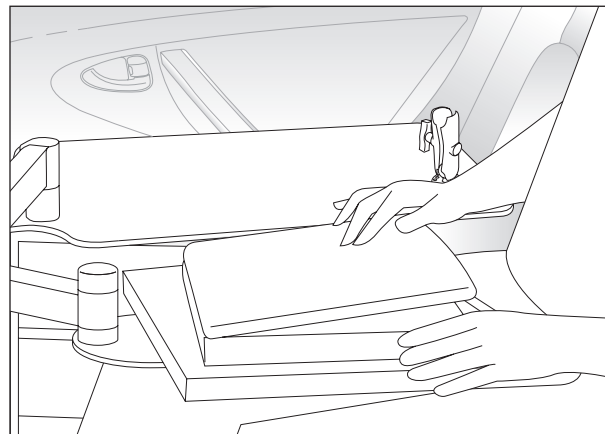

To Secure the Arm:

1. Remove laptop from tray and stow it in a safe place.

Note: Failure to remove your laptop from the tray could result in injury to you or damage to your vehicle.

2. Place the ball on the underside of the laptop tray into the double socket arm mounted on the desk top.
3. Tighten the knob on the double socket arm to secure the laptop tray onto the ball mount.

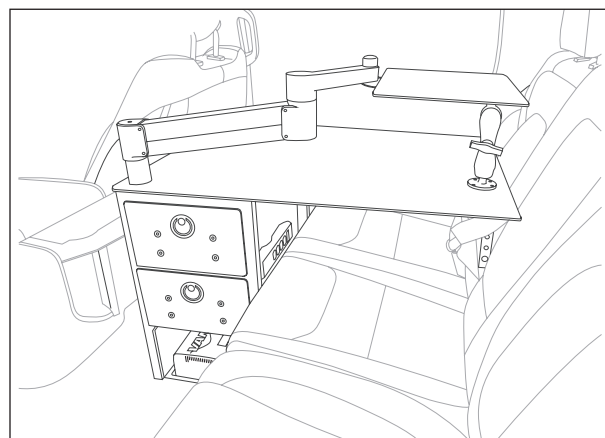

To Release the Arm:

1. Place your laptop on the laptop tray.
2. Loosen the knob on the double socket arm to release the laptop tray from the ball mount.
3. Move the laptop tray to a comfortable typing position.

Lockable Drawers

Your desk is equipped with locking storage drawers to safeguard your equipment or confidential documents.

Note: To prevent the desk drawers from opening unexpectedly keep them locked while your vehicle is moving.

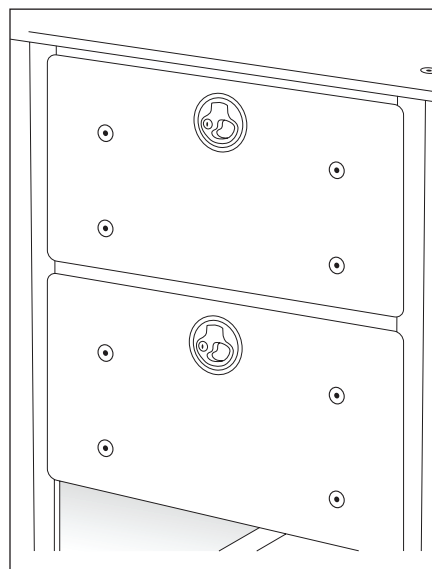

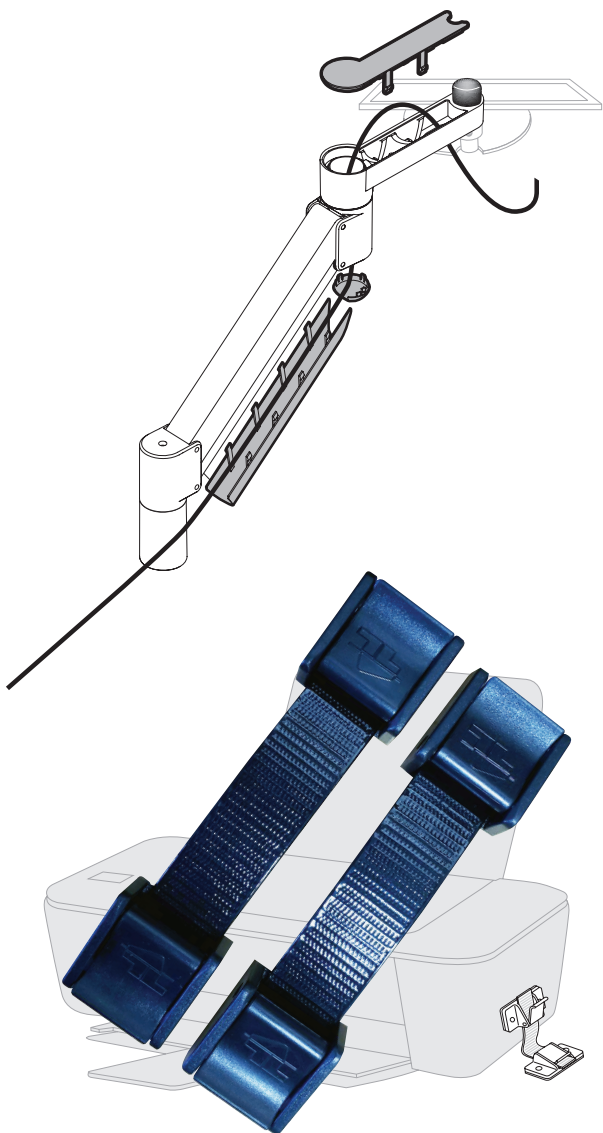

Wire Management

Your laptop's cables can be fed through the Laptop Arm by removing the wire covers and feeding the wires through the arm. Replace the covers when finished.

Printer Tie Downs

Your CrewGo Desk is supplied with a set of Thumb Locks to secure your printer to the desk. Follow the instructions in the package for the proper way to install them.

Note: Failure to use the Thumb Locks could result in injury to you or damage to your printer or the vehicle.



Get on the **go** Today!

800.755.4950 • INFO@GOERGO.COM

GOERGO.COM

Contact Ergonomic Solutions at
800.755.4950 OR SUPPORT@GOERGO.COM

for questions or assistance with
your CrewGo Mobile Office.

⚠ CAUTION



- Always secure the laptop tray while driving.
- Do not use the mobile office while the vehicle is in motion.
- Do not leave your laptop on the laptop tray while the vehicle is being driven.

Failure to follow these instructions could result in serious injury or death.
Questions: Ergonomic Solutions - 800-755-4950 or support@goergo.com

Thank you for choosing the CrewGo Desk for your mobile office solution!

Get on the  Today!

800.755.4950 • INFO@GOERGO.COM

GOERGO.COM